

StructSure DR

The StructSure D-Ring features the strength of metal and the light weight of thermoplastic. The StructSure family look is completed when used in conjunction with the StructSure Hook, Tri-Glide and Aerohead.

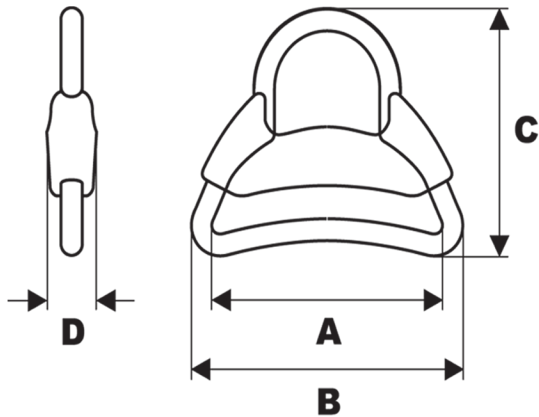

	Material	Color	A	B	C	D
StructSure DR 40						
240-0000	A, S	B/P, B/B	38.1	45.0	38.1	8.5